

AC & DC ELECTRIC WINCHES

Features

- Two-braking system mechanical and dynamic
- Overload protection
- Fully-enclosed gearing
- Machine cut and hardened gears
- Lightweight
- CE rated
- Emergency handle
- Quick connection to davit
- Pendant and power cord included
- Easy bolt on winch to OZ davit cranes

Capacity

OZACW (110V AC): 1200 lbs.

OZACW (110V AC): 1200 lbs.

Custom Overload Settings Available

| Load Capacity Based on the Amount of Cable | 3/16" Cable | 1/4" Cable |
|--|-------------|------------|
| 1st Layer (lbs) | 800 | 1200 |
| Mid. Drum (lbs) | 800 | 1120 |
| Full (lbs) | 800 | 850 |

| Winch Speed Based on Load & Cable on the Drum | First Layer | Full |
|---|-------------|------|
| AC, No Load (ft/min) | 23 | 35 |
| AC, Full Load (ft/min) | 12 | 16 |
| DC, No Load (ft/min) | 21 | 33 |
| DC, Full Load (ft/min) | 5.5 | 8 |

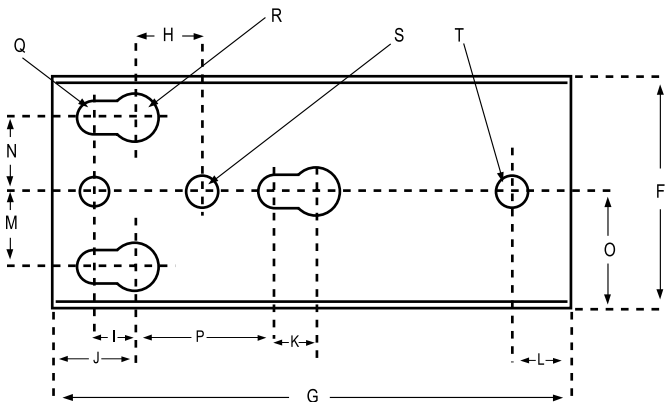
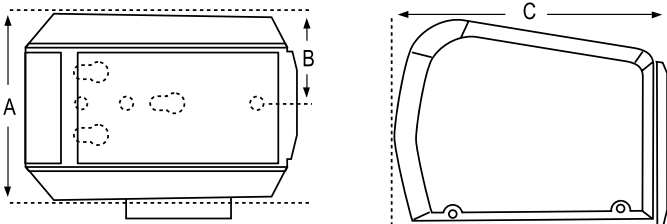

Drum Capacity

3/16" diameter cable=90'

1/4" diameter cable=45'

Pendant/ Power Cord Length

12V DC: 10' Pendant / 25' Power Cord

110V AC: 10' Pendant / 10' Power Cord

Net Weight

OZACW – 22 lbs.

OZDCW – 24 lbs.



OVERLOAD
PROTECTED



MADE IN USA



You
Tube

Standard - CE

OZACW



OZDCW



3 minutes of
continuous use
15 minute cool down

Dimensions – All Models (in)

| | |
|---|---------|
| A | 7.4375 |
| B | 3.5781 |
| C | 10.8125 |
| D | 8.1875 |
| E | 8.125 |

Mounting Plate

Mounting Plate Dimensions – All Models (in)

| | | | | | |
|---|--------|---|--------|---|-------|
| F | 3.625 | K | .625 | P | 3 |
| G | 8.6875 | L | 1 | Q | .5312 |
| H | 1.1875 | M | 1.25 | R | .7812 |
| I | .625 | N | 1.25 | S | .4262 |
| J | 1.375 | O | 1.8125 | T | .50 |

*Dimensions are for reference only and subject to change without notice.

Galvanized and Stainless Steel Wire Rope

| | | |
|-------------|-------------|--------------------------------|
| OZGAL.19-90 | 3/16" x 90' | Galvanized cable assembly |
| OZSS.19-90 | 3/16" x 90' | Stainless Steel cable assembly |
| OZGAL.25-45 | 1/4" x 45' | Galvanized cable assembly |
| OZSS.25-45 | 1/4" x 45' | Stainless Steel cable assembly |